

Southwestern Parkway Combined Sewer Overflow Basin

November 1, 2016



LOUISVILLE
METRO
PARKS

Progressive Design Build Team



ULLIMAN SCHUTTE

BURGESS & NIPLE





Ground Rules

- Feel free to quote yourself, not others. However, if you want to be quoted, be sure to say so.
- Qualify your comments if further vetting is required
- *All concerns will be heard.* Some upon request, others at the end.
- *Name Tents – Stand name tent on edge to be recognized*
- *The Parking Lot - Distracting but important non-agenda items*



PRIORITIES





Why are we Convening?

Stakeholder meetings shall be for the purpose of discussing any concerns Stakeholders may have with the Project's

CONSTRUCTION

PUBLIC OUTREACH

INCLUSION & DIVERSITY



What's most important to get done?

Committee Top 3 Priorities
([Link to Prezi](#))



MSD IN-KIND SERVICES

Pumping Station



Pavilion

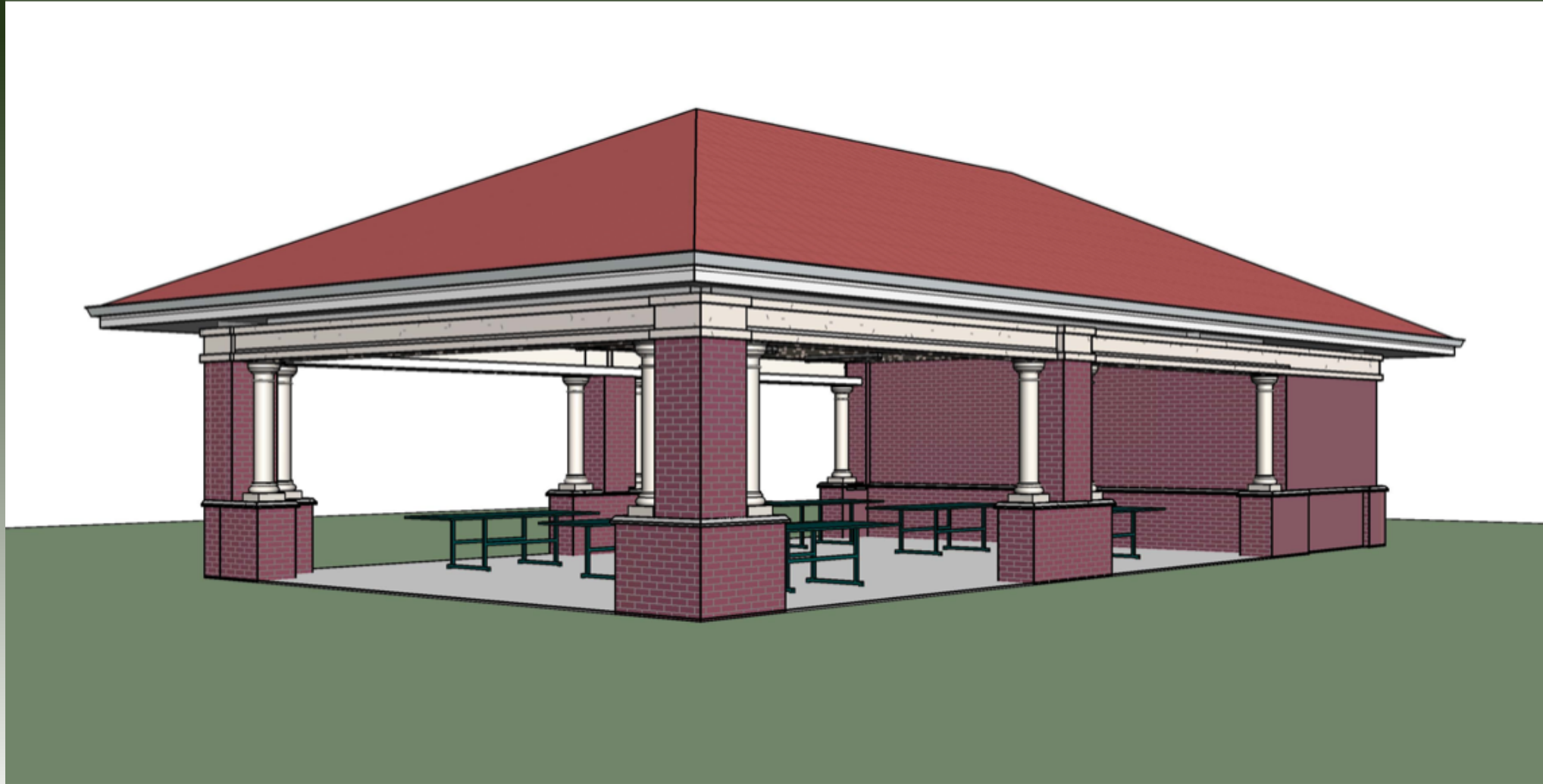

Pavement Improvements

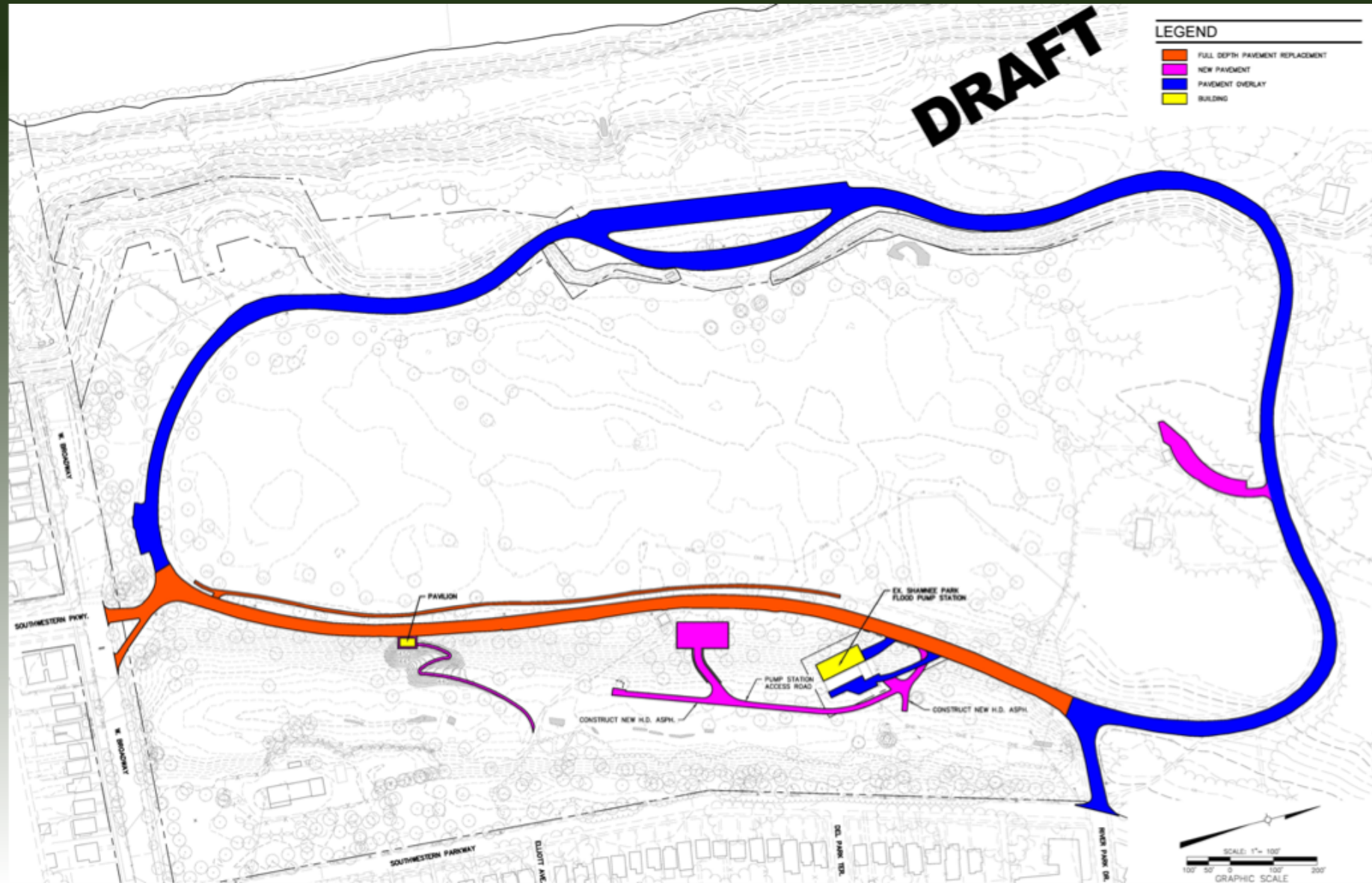



Metro Park Improvements



Metro Park Improvements

- Ongoing Projects
- Projects in Planning
- Timelines
- Future Opportunities

The background of the slide is a composite image. The top portion shows the dense green foliage of trees against a clear blue sky. The bottom portion shows a construction site with several large, light-colored concrete pipes stacked in the foreground. In the background, a yellow bulldozer is visible, partially obscured by the pipes and a bright, hazy light source that creates a lens flare effect across the center of the image.

CONSTRUCTION UPDATE

January, February & March Construction Activities

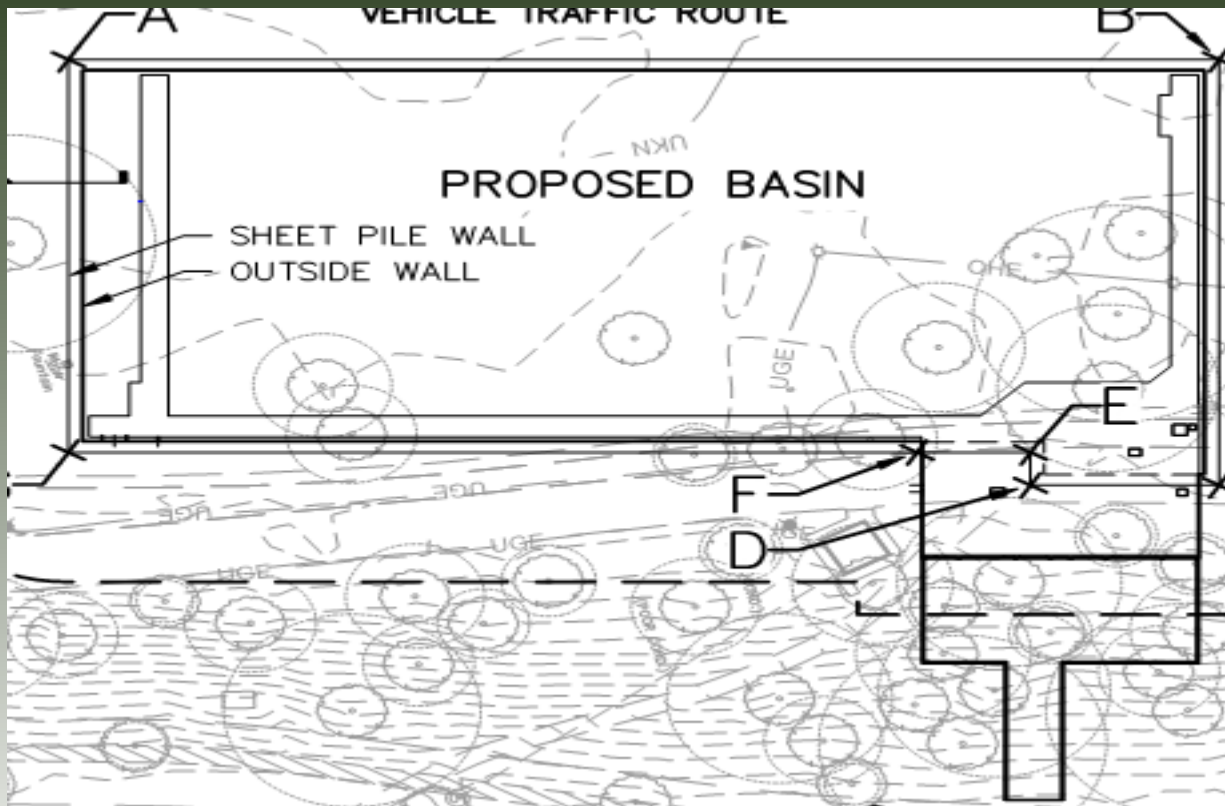

- Site Preparation Work including temporary fencing
- Installation of SWPPP Measures such as silt fence, inlet protection and wheel wash area
- Modify existing traffic striping, install signs and barricades
- Commence Excavation
- Installation of SOE Sheet Piling Around Perimeter

New Traffic Pattern

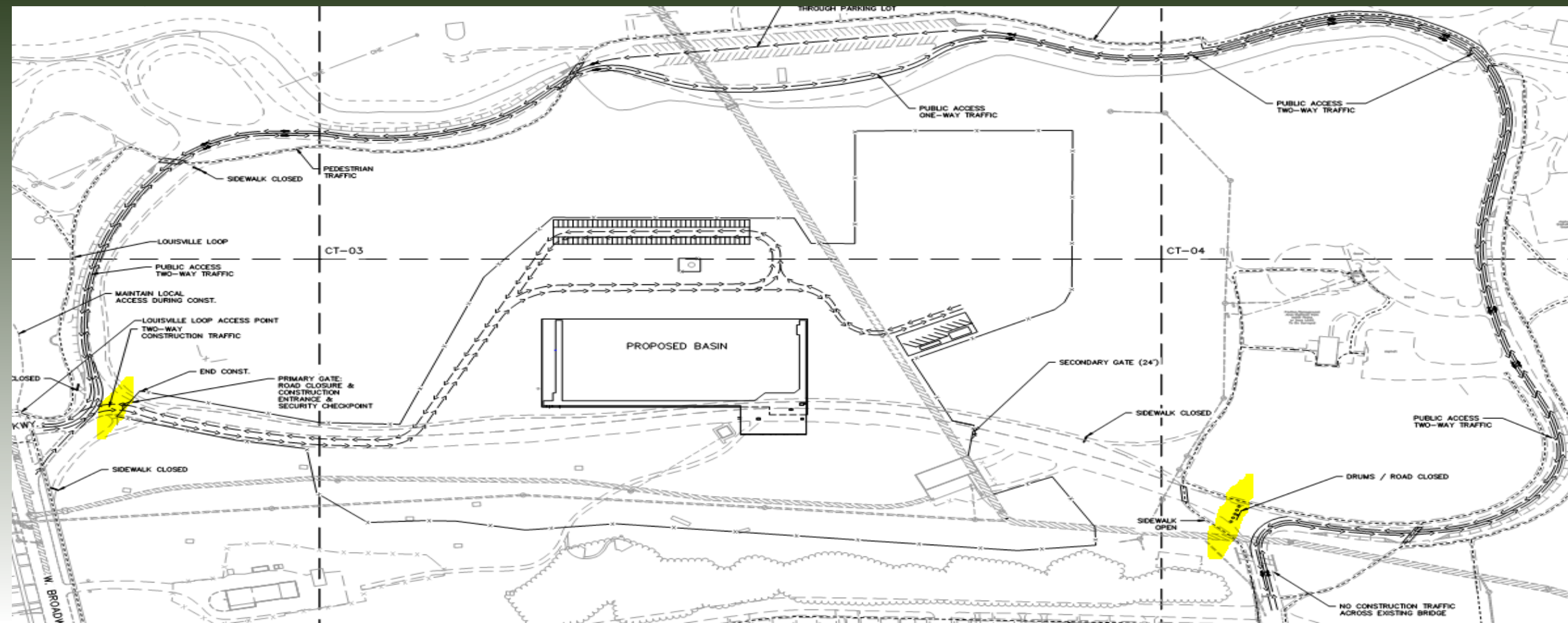

Construction Traffic Plan

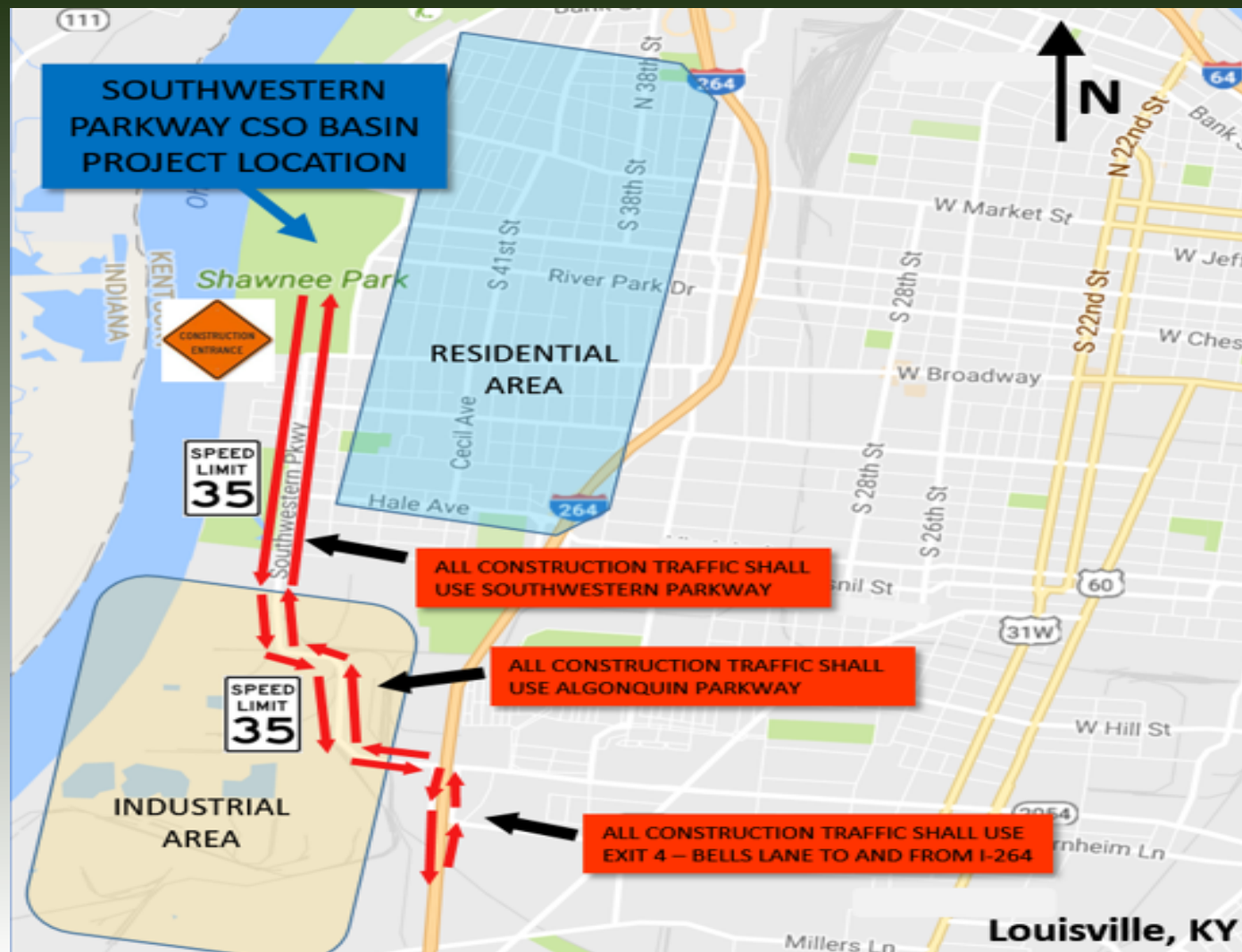

Anticipated Project Schedule

Early Start Site Work Construction		189	21-Oct-16	24-Jul-17	24-Jul-17, Early Start Site Work Construction	
Advertise for Early Start Site Work Bid Packages	1	21-Oct-16	24-Oct-16		Advertise for Early Start Site Work Bid Packages	
Bid Period for Early Start Site Work Bid Packages	17	24-Oct-16	16-Nov-16		Bid Period for Early Start Site Work Bid Packages	
Receive Subcontractor Bids for Early Start Site Work	1	16-Nov-16	17-Nov-16		Receive Subcontractor Bids for Early Start Site Work	
Analysis of Bid Packages for Early Start Site Work	2	17-Nov-16	21-Nov-16		Analysis of Bid Packages for Early Start Site Work	
Submission of Early Start GMP to MSD for Approval	7	21-Nov-16	02-Dec-16		Submission of Early Start GMP to MSD for Approval	
MSD Review and Board Approval of Early Start GMP (12/19/16)	10	05-Dec-16	19-Dec-16*		MSD Review and Board Approval of Early Start GMP (12/19/16 Mtg)	
Issue Subcontracts for Early Start Site Work	2	15-Dec-16	19-Dec-16		Issue Subcontracts for Early Start Site Work	
Secure Site Work Permit	25	21-Oct-16	29-Nov-16		Secure Site Work Permit	
Commence Early Start Site Work	1	19-Dec-16	20-Dec-16		Commence Early Start Site Work	
Install SWPPP Measures	2	20-Dec-16	22-Dec-16		Install SWPPP Measures	
Strip & Stockpile Topsoil	5	22-Dec-16	03-Jan-17		Strip & Stockpile Topsoil	
Excavate & Stockpile basin area to El. 437.00 (Initial Cut)	40	03-Jan-17	28-Feb-17		Excavate & Stockpile basin area to El. 437.00 (Initial Cut)	
Submit Support of Excavation (SOE) System	10	20-Dec-16	06-Jan-17		Submit Support of Excavation (SOE) System	
Review and Approve SOE System (MSD & B&N)	12	06-Jan-17	24-Jan-17		Review and Approve SOE System (MSD & B&N)	
Fabricate and Deliver SOE System	20	24-Jan-17	21-Feb-17		Fabricate and Deliver SOE System	
Install SOE System	85	28-Feb-17	28-Jun-17		Install SOE System	
Basin Excavation / Dewatering Work	60	13-Apr-17	10-Jul-17		Basin Excavation / Dewatering Work	
Install Deep Foundation System (If Required)	40	25-May-17	24-Jul-17		Install Deep Foundation System (If Required)	



Southwestern Parkway CSO Basin Project
The Louisville and Jefferson County Metropolitan Sewer District



DIVERSITY



Early Start Package Anticipated Workforce

- Earthwork

- 23,000 Manhours

Craft Makeup - Equipment Operators, Trucks Drivers, Common Laborers

- Support of Excavation

- 16,000 Manhours

Craft Makeup - Equipment & Crane Operators, Welders, Common Laborers



Supplier Diversity

- Overall Project Goals - 15% MBE, 6% WBE, local preference
- Early Start Package - Requirements are Optimized for Supplier Diversity
- Going Forward (Timeline of MBE Activities)

The background of the slide is a photograph of a construction site. In the foreground, several large, light-colored concrete pipes are stacked horizontally. In the background, a yellow bulldozer is visible, partially obscured by the pipes. The top of the image shows the dark green foliage of trees against a blue sky. A dark green horizontal band runs across the middle of the image, containing the text.

PUBLIC OUTREACH



Communication Strategy

Clear Neighborhood Benefits

- Clean Water
- Improved Facilities
- Enhanced Park Features

Narrowly Tailored Public Message

Over Communicate

- Message Cards
- Virtual Presence
- Attend Local Events
- Attend Churches



Narrowly Tailored Public Message

The Shawnee Park Project

The Shawnee Park Project will create a cleaner river,
provide new amenities and preserve the historic nature
of Shawnee Park



Communication Strategy

Neighborhood Benefits

- Clean Water
- Improved Facilities
- Enhanced Park Features

Over communicate Message

- Message Cards
- Virtual Presence
- Attend Local Events

Message Cards



Shawnee Park Project

Important Dates:
Construction starts: Jan 3rd 2017*
Construction ends: Dec. 31st 2018
**Construction will generally occur during the work day.*

For more information visit: shawneeparkproject.org
Or contact: Eric Browne, CEO Browne E & C Services
(800) XXX-XXXX
email: eric@brownee.com

What is the Shawnee Park Project?

The Shawnee Park Project will create a cleaner river, provide new amenities, and preserve the historic nature of Shawnee Park.

Benefits of the Project

New and improved park amenities
Improved neighborhood health and safety
Improved river water quality
Jobs and subcontracting opportunities

The Park will feature

New Open Air Pavilion	Athletic Courts & Bath house
Premium Landscaping	New Paved Parking Area
Renovated Lily Pond	Restored Walkways and Jogging Lanes



Shawneeparkprojects.

Shawnee Park Project Updates

Upcoming Events
Recent News
Stakeholder Login
Contact



Shawnee Park Project Updates

Upcoming Events
Recent News
Stakeholder Login
Contact

CONTACT

Getting in touch is easy...

Message

Contact Us

Address

33 Main Street
Louisville, KY 51423

Phone

(923) 515-1212

Email

info@shawneeparkproject.org

ibh, ut tempor quam
. Nulla facilis odio
Phasellus et justo non
et ultrices posuere
ic ornare metus quis
na pharetra molestie
erat.

etis gravida. Integer
ortor id ornare tindi-
ra viverra. Quisque
am vulputate lorem in
nec eros. Aenean in
interdum metus, et
rices sit amet, ali-
ros dictum et.

ue ligula lectus, eu
s eleifend condimen



Frequently Asked Questions

What is the project?

How much will the project cost

How is the project paid for?

Will my rates go up?

What are the benefits?

When does construction start?

When will construction end?

When will the pavilion be open?

What are the construction hours?

When will the parks improvements be complete?

When will the new restrooms be complete?

What should I expect during construction?

Is it safe to use the park?

How can I apply for a job on the project?

How can I bid to subcontract work on the project?

When will the river be clean?

How will the new pavilion look?

Is it safe for my kids to play in the park?

How will curious kids be kept safe?

Will there be odors in the park when is done?

Can the basin leak?

What streets will be affected and when?

Will the streets be kept clean?

Will my bus route change?

Will my house be affected?

Will my business be affected?

Will bus routes be affected?

Who do I call if I see a problem during construction?

Where can I visit to get more information?

Who can I call for more information?



OFFICIAL PUBLIC NOTIFICATIONS

MEDIA CHANNELS

- Stakeholders Channels
- Project Websites
- Public TV/Radio
- Community Advocacy Groups
- Local Businesses
- Churches
- Events

DOOR TO DOOR



Door to Door

DOOR HANGER GOES HERE



END



STAKEHOLDER COMMUNICATIONS

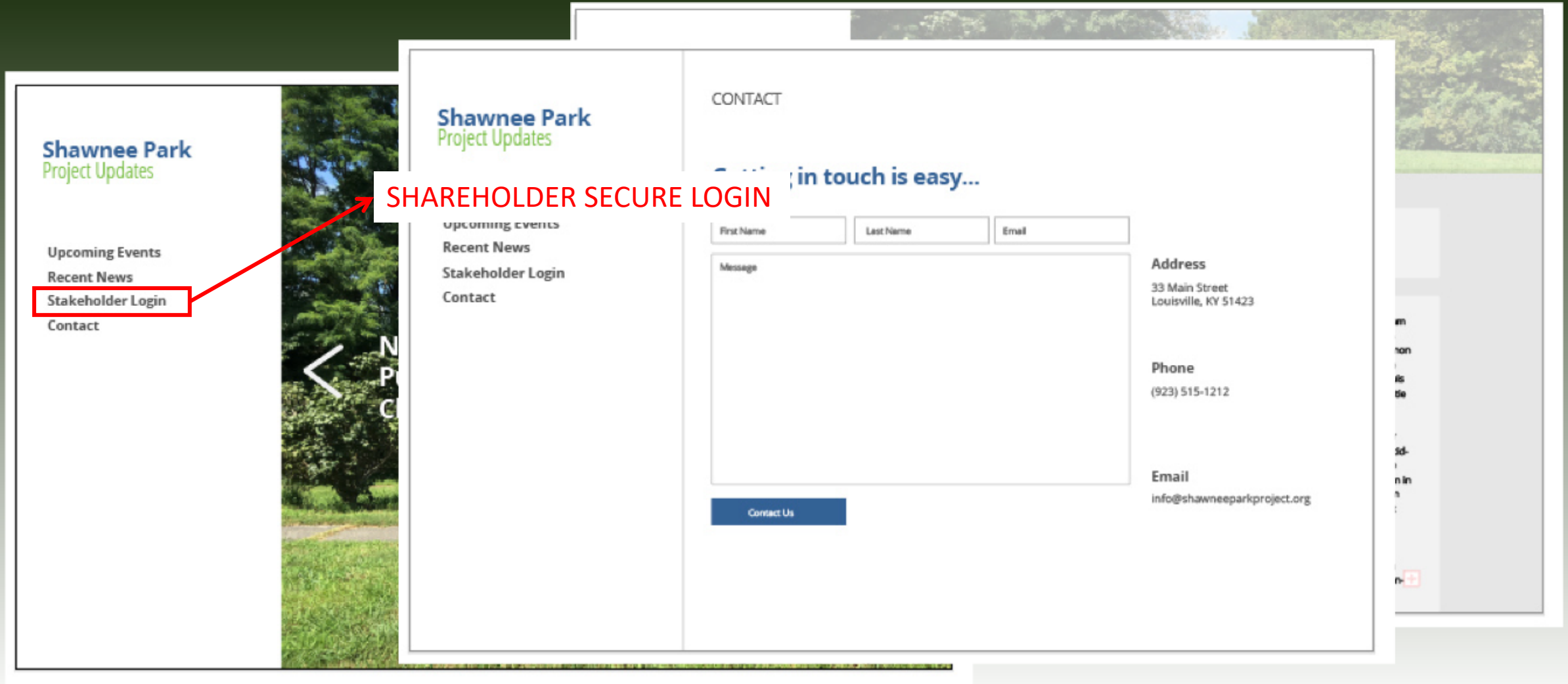

The image shows a screenshot of the Shawnee Park Project Updates website. On the left sidebar, the 'Stakeholder Login' link is highlighted with a red box. A red arrow points from this box to a larger, semi-transparent window that displays the 'Stakeholder Secure Login' form. The form includes fields for First Name, Last Name, and Email, a large text area for a message, and a 'Contact Us' button. To the right of the form, contact information is listed: Address (33 Main Street, Louisville, KY 51423), Phone ((923) 515-1212), and Email (info@shawneeparkproject.org).

Shawnee Park Project Updates

Upcoming Events
Recent News
Stakeholder Login
Contact

Stakeholder Secure Login

CONTACT

... in touch is easy...

First Name Last Name Email

Message

Contact Us

Address
33 Main Street
Louisville, KY 51423

Phone
(923) 515-1212

Email
info@shawneeparkproject.org

BIG MOMMA'S SOUL KITCHEN

[Big Momma's Christmas Dinner](#)

