

Camp Taylor Sanitary Sewer Improvement Project

IOAP Public Input Meeting

Tuesday, June 17, 2014

Holy Family Resource Center



Camp Taylor Presentation Agenda

Communicate

- Project Background
- Project Approach
- Project Input Opportunity



Project Background

Camp Taylor Sanitary Sewers



Camp Taylor Project Background

- The Camp Taylor sewer system was constructed in the early 1900's to serve U.S. Army training facilities.
- Post-Army development did not utilize current design requirements.



Camp Taylor Project Background

- As a result we are left with sewers under homes, multiple sewers crossing some properties, and undersized sewers receiving more flow than they are capable of carrying.
 - This lack of capacity is a serious cause of discharges and back-ups (along with root blockages and decaying pipes).
- Maintenance is difficult do to the existing sewer conditions, and lack of construction plans.



Camp Taylor Project Background

- Sanitary Sewer Evaluation Study (SSES) was completed in February, 2011.
- The project area included all areas that drain to a trunk sewer along Nightingale Road.
- The scope of work included:
 - CCTV inspections
 - Smoke testing
 - Dye testing
 - Wet weather observations
 - Private property inspections



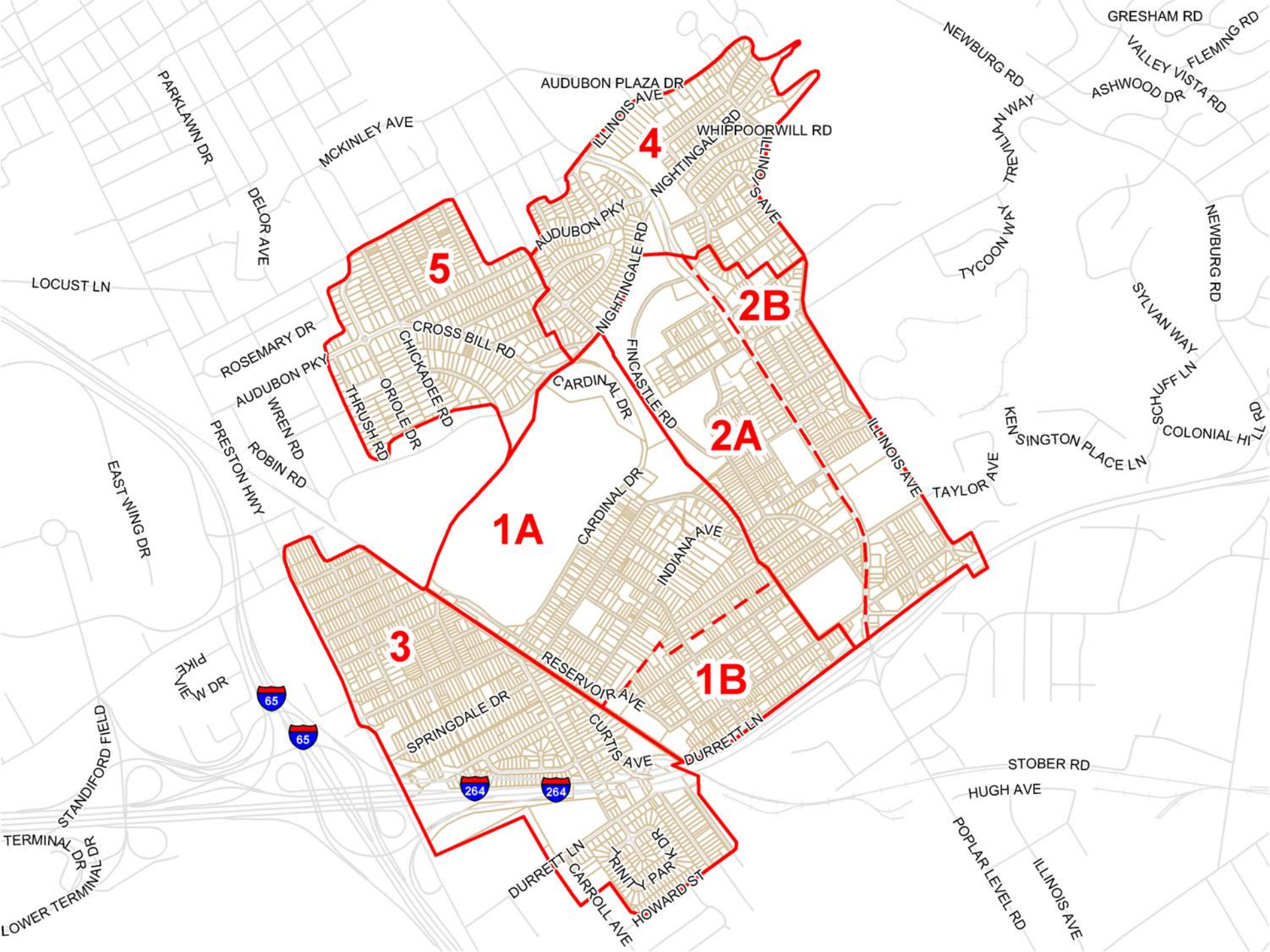

PARKLAWN DR
DELORE AVE

MCKINLEY AVE

AUDUBON PLAZA DR

ILLINOIS AVE

4

WHIPPOORWILL RD

NEWBURG RD
TYCOON WAY
FLEMING RD

GRESHAM RD
VALLEY VISTA RD
ASHWOOD DR

LOCUST LN

ROSEMARY DR
AUDUBON PKY
WREN RD
PRESTON HWY
ROBIN RD

5

CROSS BILL RD
CHICKADEE RD

AUDUBON PKY
NIGHTINGALE RD
FINCASTLE RD

2B

CARDINAL DR

2A

KENSINGTON PLACE LN
TAYLOR AVE

SYLVAN WAY
SCHUFF LN

NEWBURG RD

COLONIAL HI

EAST WING DR

1A

CARDINAL DR

INDIANA AVE

ILLINOIS AVE

PIKE
VIEW DR

65

65

3

SPRINGDALE DR

RESERVOIR AVE
CURTIS AVE

1B

DURRETT LN

STOBER RD
HUGH AVE

264

264

DURRETT LN
CARROLL AVE

TRINITY PAR
K DR
HOWARD ST

POPLAR LEVEL RD
ILLINOIS AVE

TERMINAL DR
LOWER TERMINAL DR

STANDIFORD FIELD

Camp Taylor Project Background

SSES Recommendations

- Disconnect down spouts and sump pumps.
- Redirect existing yard drains and catch basins.
- Review existing draining system.
- Rehabilitate or replace sanitary sewers.
- Abandon sewers located beneath structures.



Project Approach

Camp Taylor Sanitary Sewers



Camp Taylor Project Approach

Types of Projects

- Sewer Separation / Drainage Projects
- Sewer Rehabilitation Projects
- Sewer Replacement Projects
- Sewer Replacement & Rehabilitation Projects

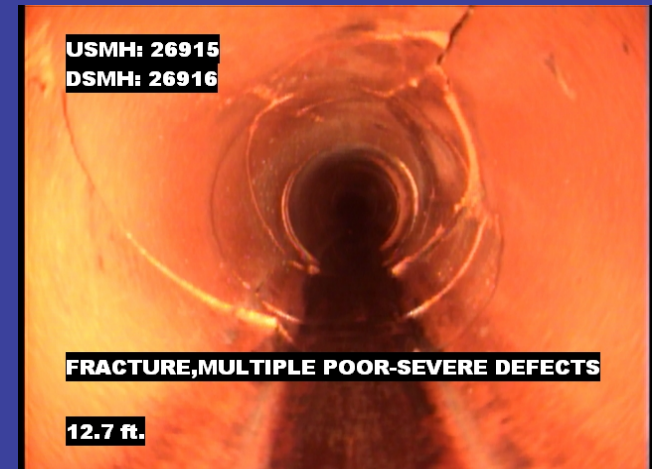

Camp Taylor Project Approach

Sewer Separation / Drainage Projects

- 19 projects indentified (Areas 2-5)
 - 14 complete



Camp Taylor Project Approach

Sewer Rehabilitation Projects

- Area 3: approximately 15,780 LF & 80 MH's
 - Construction ongoing
 - to be completed approximately 8/31/14
 - Springdale replacement to be completed separately
- Area 4: 5,087 LF & 83 MH's
 - Construction Complete
- Area 5: 3,565 LF & 28 MH's
 - Construction Complete
- Private Property Inflow Reduction
 - On-going

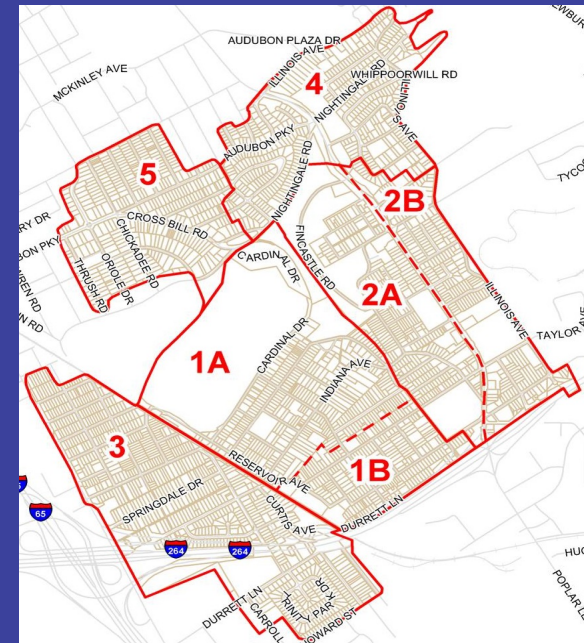

4.6 Miles of Sewer, 191 Manholes

Camp Taylor Project Approach

Sewer Replacement Projects

- Area 1A: approximately 19,200 LF & 92 MH's
 - Construction to begin approximately 9/1/14
 - to be completed approximately 6/30/15
- Area 1B: approximately 7,700 LF & 37 MH's
 - Construction ongoing
 - to be completed approximately 4/30/15

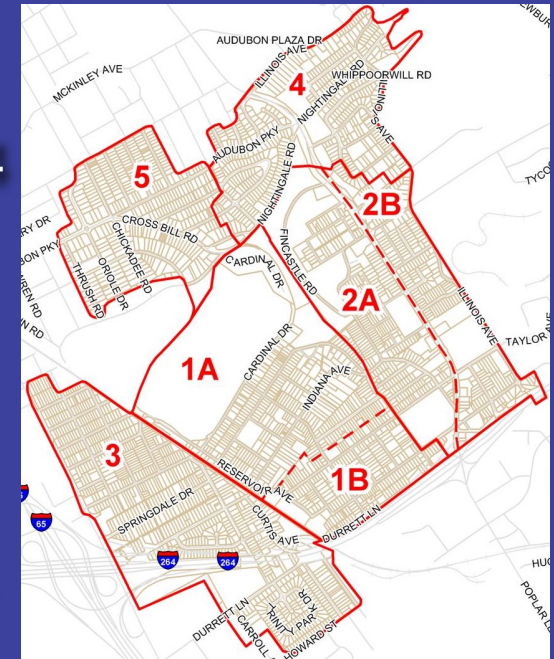

Camp Taylor Project Approach

Sewer Replacement & Rehabilitation Projects

- Area 2A: New: approx. 17,400 LF & 115 MH's,
Rehab: approx. 5,200 LF & 30 MH's
 - Construction to begin approximately March 2015
 - to be completed approximately March 2017
- Area 2B: New: approx. 15,400 LF & 82 MH's,
Rehab: approx. 12,700 LF & 90 MH's
 - Construction to begin approximately March 2015
 - to be completed approximately March 2017

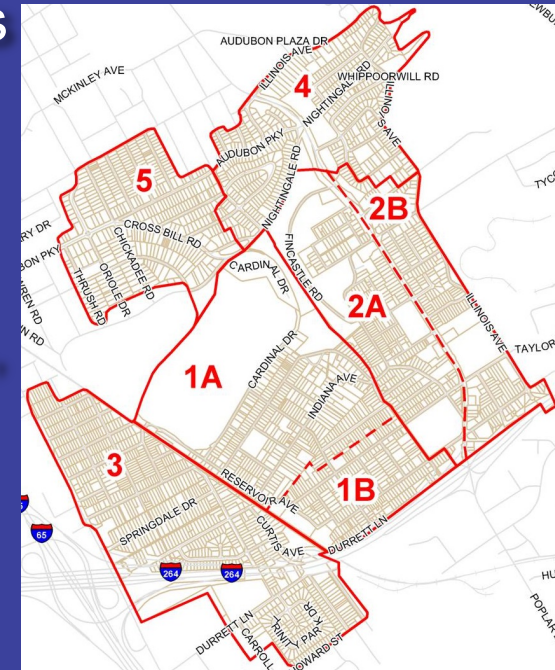

All work complete by December 2017



Nightingale Pump Station & CSO Storage Basin

IOAP Public Input Meeting

Tuesday, June 17, 2014

Holy Family Resource Center



Nightingale Presentation Agenda

- Communicate
 - Existing Conditions
 - The Original Plan
 - The Proposed Changes
 - The Path Forward
- Provide Input Opportunity



Existing Conditions

Nightingale Pump Station



Nightingale Pump Station

- 27 MGD
- 23,972 Acre Service Area
- Diverts Beargrass Interceptor (BGI) & Beargrass Interceptor Relief (BGIR)
- Serves Camp Taylor and Surrounding Neighborhoods
- Interceptor Relief, CSO 018



Nightingale Pump Station



Nightingale Site

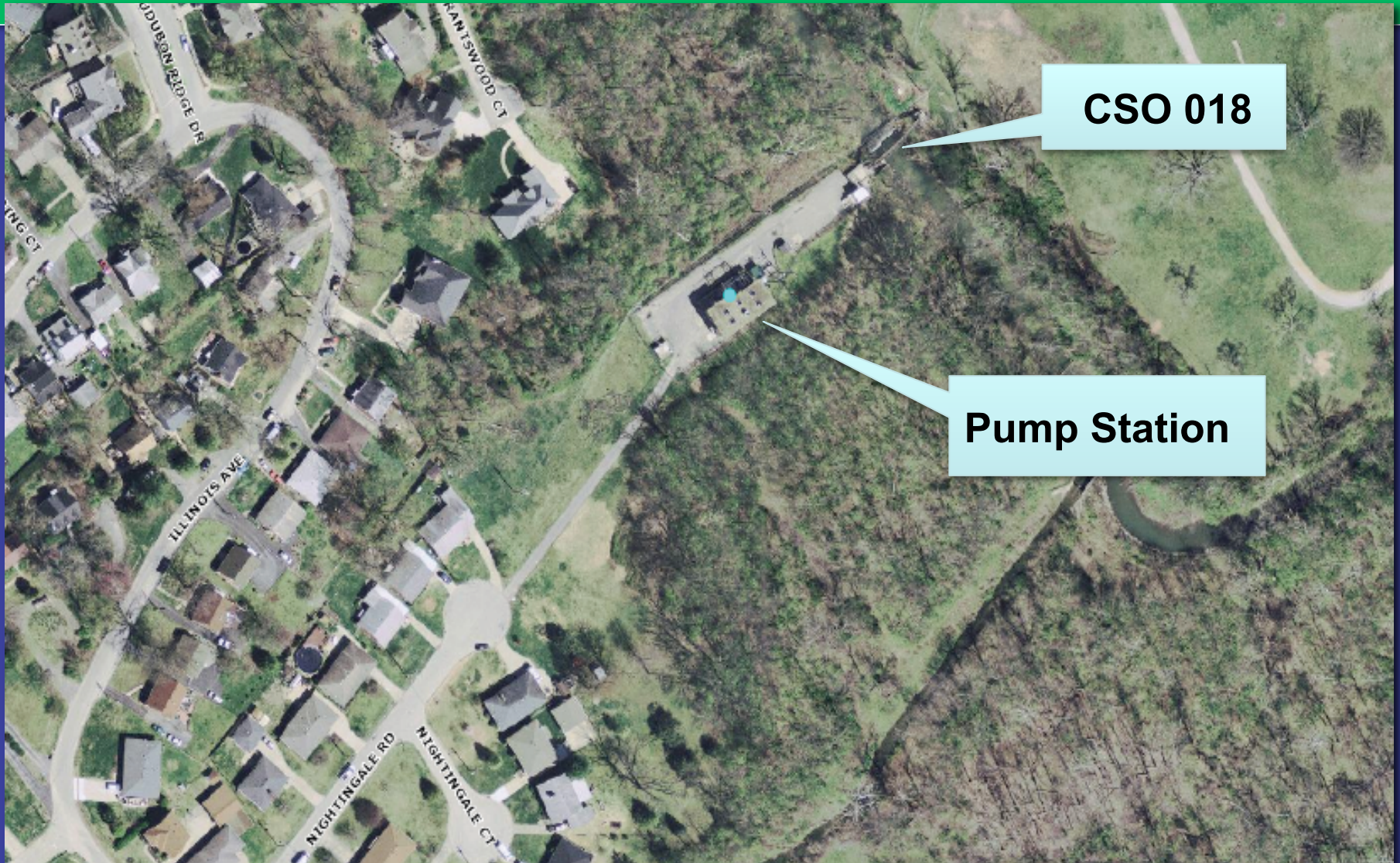

CSO 018

Pump Station

Nightingale Service Area (Camp Taylor)

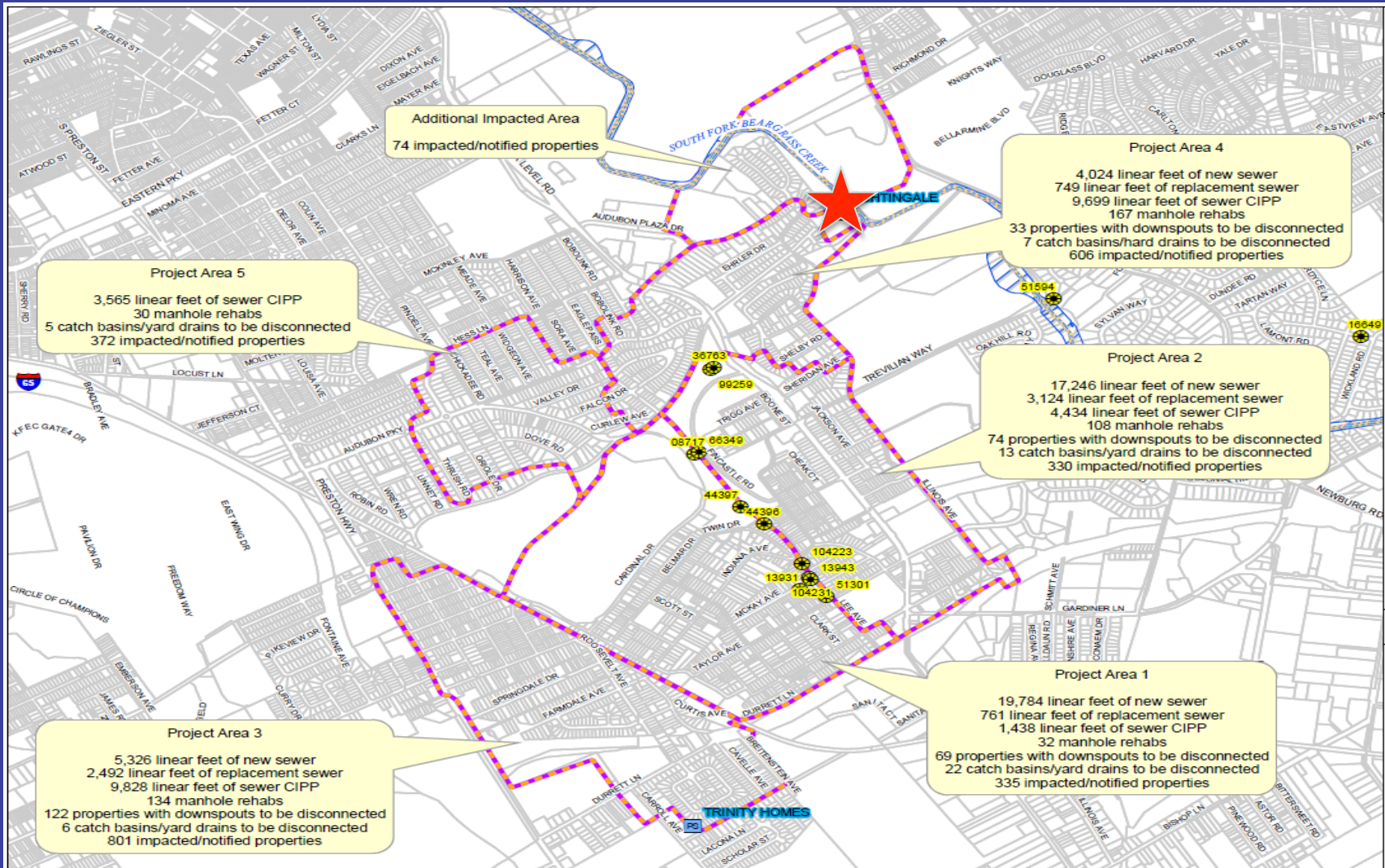

Nightingale Service Area

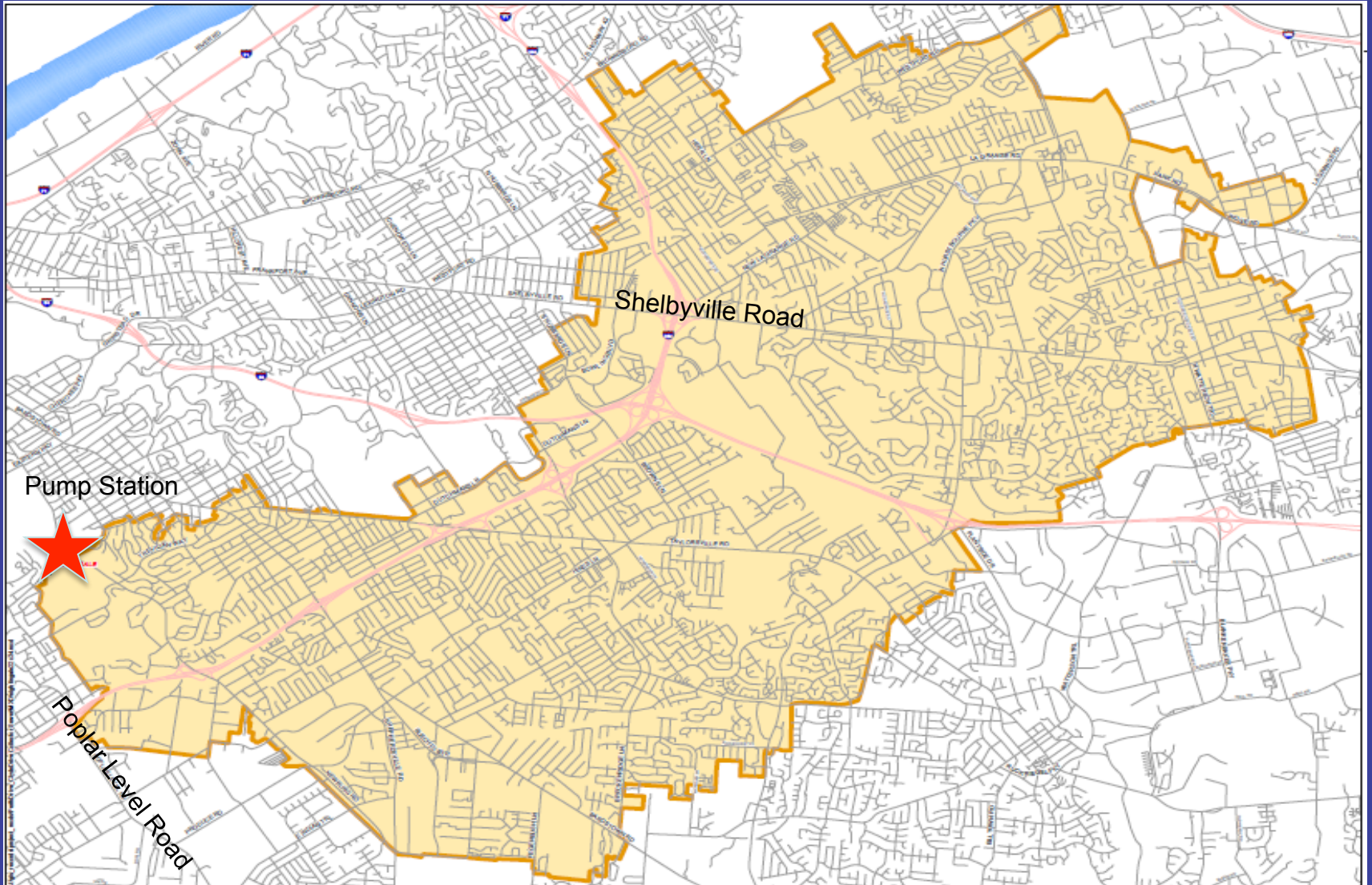

The Original Plan

Nightingale Pump Station Replacement and New Force Main



2009 IOAP Recommendations

- Nightingale Pump Station Project
 - Scope
 - 60 MDG (27 MGD Existing)
 - 5780 LF New 42” Force Main
 - \$15,710,000
 - Location
 - Vacant Property Adjacent to Existing Site
 - Completion Date
 - December 16, 2016



The Proposed Changes

Nightingale Pump Station Replacement and CSO Storage Basin



Revised Recommendations

Nightingale Pump Station Project

Scope

33 MDG

7.7 MG Off-line Storage

\$20,500,000

Sewer Gravity In - Pump Out

Collects Flow from CSO018

Overflows Reduced to **Zero** per typical year

Location

Vacant Property Adjacent to Existing Site



ALLINGTOS AVE

NIGHTINGALE RD

NIGHTINGALE CT

Control Building

Nightingale PS Project

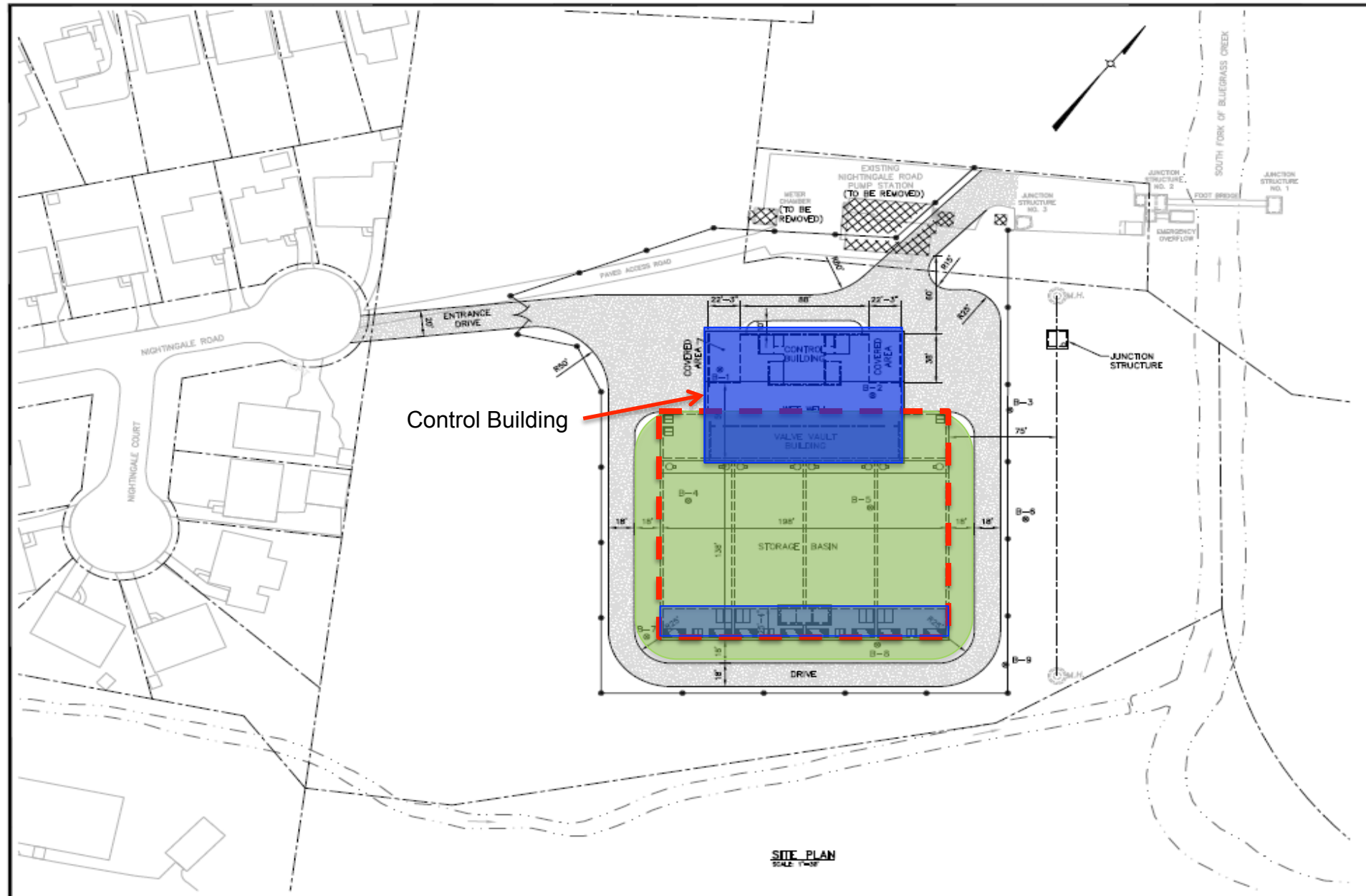

Nightingale PS Project

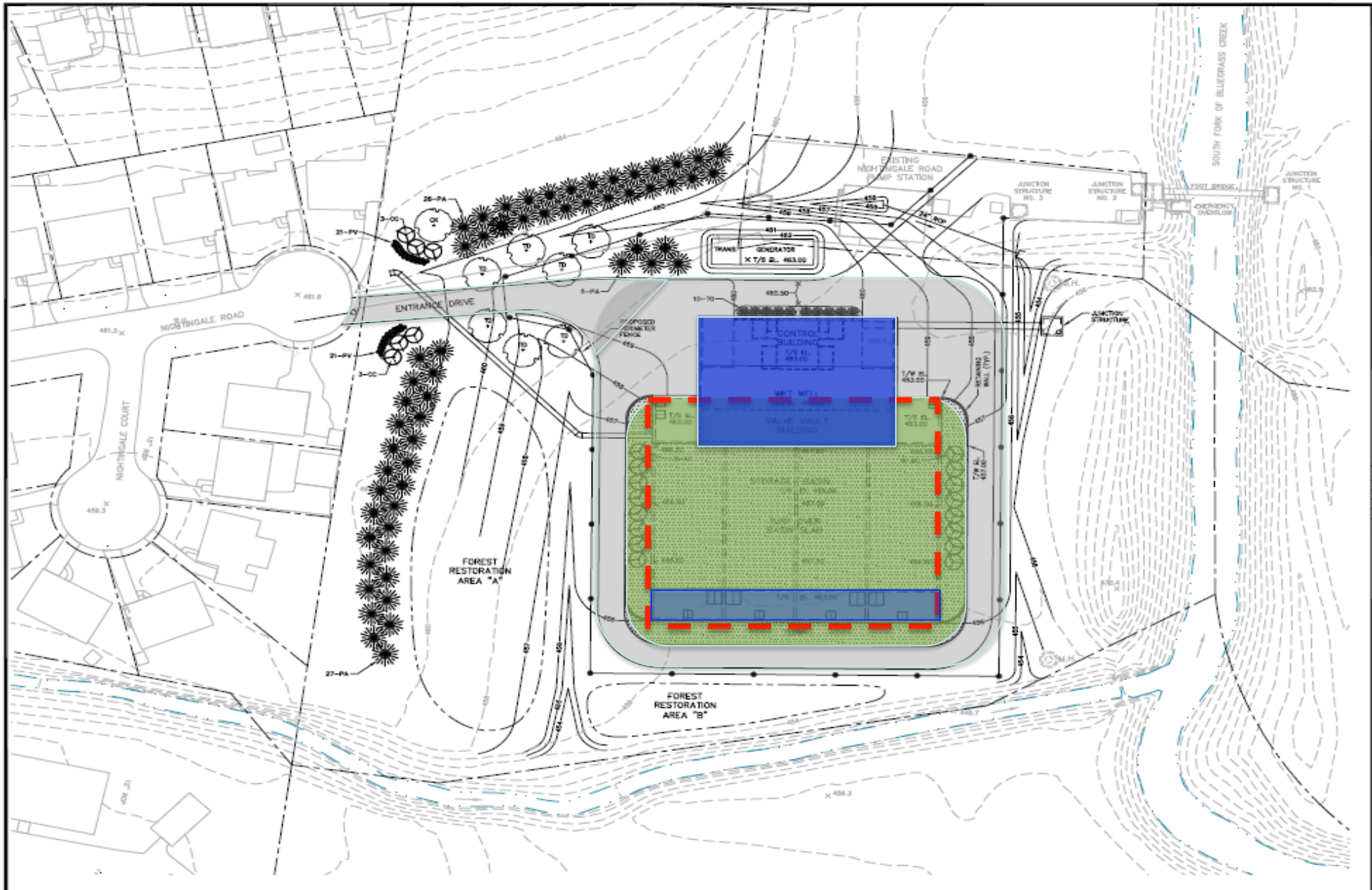

Pump Station Building 30% Rendering



Pump Station Building 30% Rendering



Moving Forward



Moving Forward

- Planning Complete
- Preliminary Design Complete
- Final Design September 2014
- Advertise Construction October 2014
- Construction Start January 2015
- Consent Decree Deadline Dec. 31, 2016

Moving Forward

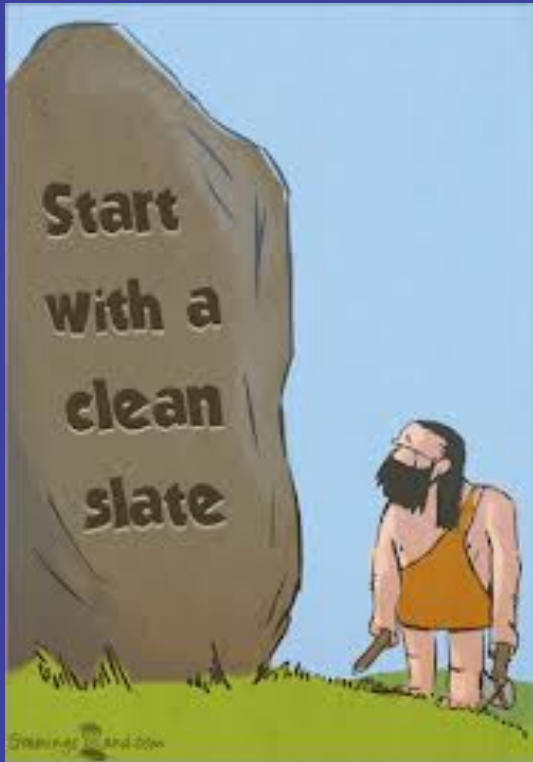

- Public involvement – Today
 - Communicate Concepts
 - Solicit Feedback/Suggestions (Site Layout, Building Aesthetics, etc..)
- Public Involvement – Next Phase
 - Communicate Design and Construction Schedule
 - Solicit Feedback & Suggestions

Public Input Sought

- Provide written comments by July 17, 2014
- Send comments via email
commentsIOAP@msdlouky.org

- Mail comments

MSD IOAP Project Comments

Attention: Project WIN Program Manager

700 West Liberty St.

Louisville, KY 40203

